

MoliCare® Premium Mobile

General Product Description/Intended Purpose

Intended Purpose:

MoliCare® Premium Mobile are pull-up pants for incontinence care.

The products are suitable for usage in case of bladder weakness with several severities, urinary and fecal incontinence with several severities and for usage of toilet training.

The products are intended for mobile to semi-mobile patients and restless or dement patients. The products are for single use only and should be regular changed as needed.

The products can be used in home care environment and professional healthcare facilities. The application can be performed by lay person and/or health care professional.

Application/Indication

MoliCare® Premium Mobile are suitable for usage in case of bladder weakness with several severities, urinary and fecal incontinence with several severities and for usage of toilet training.

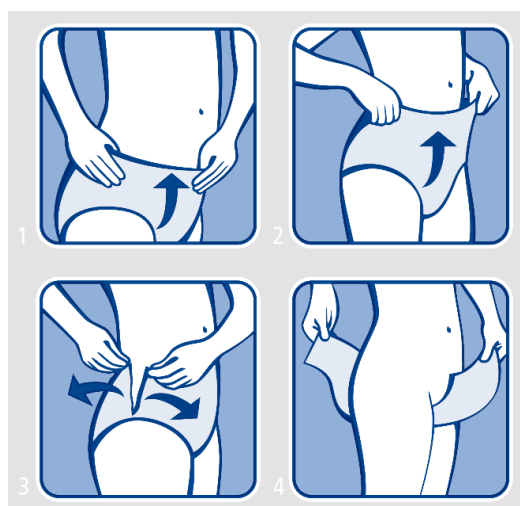

Reference Numbers*

Packaging		XS	S	M	L	XL
	Hip-/waist girth (cm)	45–70	60–90	80–120	100–150	130–170
P14	5 drops / green	-	915861	915852/915862/915812	915853/915863/915813	915854/915855
	6 drops / blue	915840	915831/915841	915832/915842/915822	915833/915843/915823	915834/915844
	8 drops / purple	-	915871/915881	915872/915882	915873/915883	915874/915875
	10 drops / grey	-	-	915878/915884	915879/915885	915880/915886
P30	5 drops / green	-	915644	915642	915643	915645
	6 drops / blue	915638	915634	915635	915636	915637
	8 drops / purple	-	915639	915640	915641	915646
	10 drops / grey	-	-	915652	915647	915649
P2	5 drops / green	-	915615	915616	915617	915648
	6 drops / blue	915618	915619	915620	915621	915622
	8 drops / purple	-	915623	915624	915625	915656
	10 drops / grey	-	-	915825	915826	915829

*the full assortment may not be available in all countries

MoliCare® Premium Mobile

Single use Device

Reusing a single-use medical device is dangerous. Reprocessing devices, in order to reuse them, may seriously damage their integrity and their performance. Information available on request. Reuse of the product could lead to microbiological contamination and/or mild infections of the skin.

Product disposal

To minimize the risk of potential infection hazards, or environmental pollution, disposable components of MoliCare® Premium Mobile should follow disposal procedures according to applicable and local laws, rules, regulations and infection prevention standards.

Incident Reporting

For a patient/user/third party in the European Union and in countries with identical regulatory regime (Regulation 2017/745/EU on Medical Devices); if, during the use of this device or as a result of its use, a serious incident has occurred, please report it to the manufacturer and/or its authorised representative and to your national authority.

Product performance characteristics

MoliCare® Premium Mobile 5 drops / green:

Characteristics	unit	XS	S	M	L	XL
total weight:*	[g]	-	54	58	72	77

* ≤ ± 10% tolerance

MoliCare® Premium Mobile 6 drops / blue:

Characteristics	unit	XS	S	M	L	XL
total weight:*	[g]	67	69	78	95	105

* ≤ ± 10% tolerance

MoliCare® Premium Mobile 8 drops / purple:

Characteristics	unit	XS	S	M	L	XL
total weight:*	[g]	-	82	92	111	116

* ≤ ± 10% tolerance

MoliCare® Premium Mobile 10 drops / grey:

Characteristics	unit	XS	S	M	L	XL
total weight:*	[g]	-	-	105	117	122

* ≤ ± 10% tolerance

Material characteristics

Part	Material
chassis	polypropylene non-woven, hydrophobic, breathable, white
back sheet:	polyethylene film with polypropylene nonwoven layer, white, breathable
absorbent core (3-layer):	1. layer: kraft pulp* 2. layer: kraft pulp* - with superabsorbent polymer 3. layer: kraft pulp*, „Curled Fiber“ *bleached elementary chlorine free
adhesive:	hotmelt adhesive
top sheet:	polypropylene - nonwoven, hydrophilic, white
cuff:	polypropylene - nonwoven, hydrophobic, white
elastics:	polyurethane based elastics for leg gathers, standing cuffs, waist and hip area
wetness indicator:	water soluble ink

MoliCare® Premium Mobile

Product characteristics

Dimensions	XS	S	M	L	XL
total length*:	730	730	800	900	960
total width*:	550	550	660	810	900
total width crotch*:	200	200	220	220	210
absorbent core length*:	490	490	490	580	580
absorbent core width*:	180	180	180	180	180
absorbent core width crotch*:	140	140	140	140	140

* ≤ ± 10% tolerance

Labelling

9-digit LOT-code

e.g.:  9 001 02 82 2
year 201X internal key internal key internal key cumulated
check sum

Manufacturing date

e.g.:  2019 08 07
year month day

Expiry date

e.g.:  2024 08 01
year month day

Shelf life: 5 years

Medical Device



Keep dry



Do not reuse



CE-marking



Latest date of revision: 2021-02-26